

Instruction manual
Manuel d'instructions
Manual de instrucciones
Bedienungsanleitung

BERNETTE 134D/134

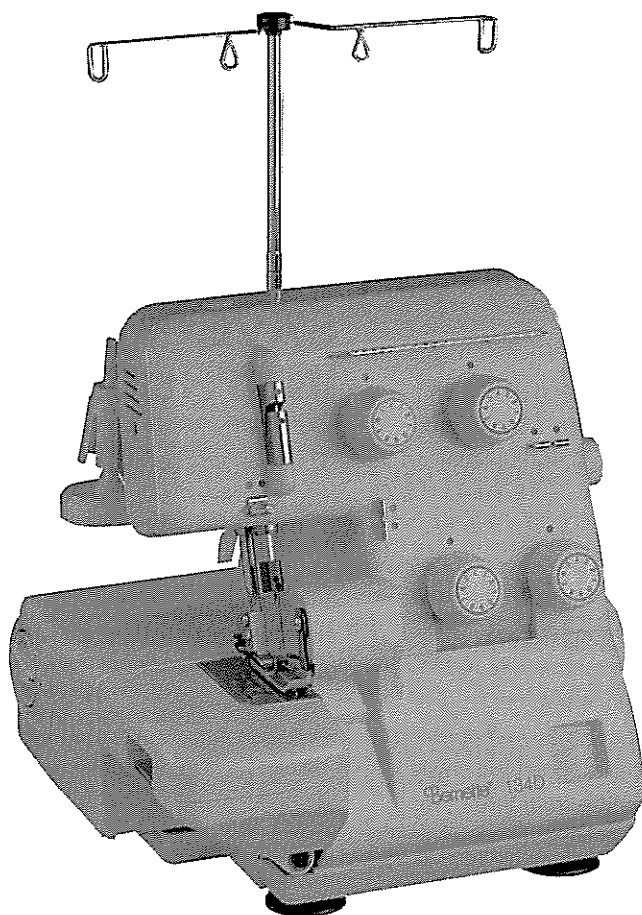

IMPORTANT SAFETY INSTRUCTIONS

When using an electrical appliance, basic safety precautions should always be followed, including the following: Read all instructions before using this overlock sewing machine.

DANGER _____ To reduce the risk of electric shock:

1. The appliance should never be left unattended when plugged in.
2. Always unplug this appliance from the electric outlet immediately after using and before cleaning.
3. Always unplug before re-lamping. Replace bulb with same type rated 240V/15W, 230V/15W, 115V/15W.

WARNING _____ To reduce the risk of burns, fire, electric shock, or injury to persons:

1. Do not allow this appliance to be used as a toy. Close attention is necessary when this appliance is used by or near children.
2. Use this appliance only for its intended use as described in this manual. Use only attachments recommended by the manufacturer as contained in this manual.
3. Never operate this appliance if it has a damaged cord or plug, if it is not working properly, if it has been dropped or damaged, or dropped into water. Return the appliance to the nearest authorized dealer or service center for examination, repair, electrical or mechanical adjustment.
4. Never operate the appliance with any air openings blocked. Keep ventilation openings of the sewing machine and foot controller free from the accumulation of lint, dust, and loose cloth.
5. Keep fingers away from all moving parts. Special care is required around the sewing machine needle and knife.

6. Always use the proper needle plate. The wrong plate can cause the needle to break.
7. Do not use bent needles.
8. Do not pull or push fabric while stitching. It may deflect the needle causing it to break.
9. Switch the sewing machine off "O" when making any adjustments in the needle area, such as threading needle, changing needle, threading looper, or changing presser foot and the like.
10. Always unplug the machine from the electrical outlet when removing covers, lubricating, or when making any other user servicing adjustments mentioned in the instruction manual.
11. Never drop or insert any object into any opening.
12. Do not use outdoors.
13. Do not operate where aerosol (spray) products are being used or where oxygen is being administered.
14. To disconnect, turn all controls to the off "O" position, then remove plug from outlet.
15. Do not unplug by pulling on cord. To unplug, grasp the plug, not the cord.

SAVE THESE INSTRUCTIONS

"This overlock sewing machine is intended for household use only."

If this machine was purchased in a foreign country, please request an instruction manual in your own language from the National Importer or a Bernina dealer.

Contents

| | |
|-----------|-------------------------------------|
| 1 | Safety regulations |
| 5 | Contents |
| 7 | Details of the machine |
| 7 | -Details of the machine |
| 9 | Preparing the machine |
| 9 | -Accessories |
| 9 | -Accessory Box |
| 9 | -Looper cover |
| 9 | -Cloth plate cover |
| 11 | -Attaching the foot control |
| 11 | -Sewing speed |
| 11 | -Assembling the thread stand |
| 11 | -Thread cones |
| 11 | -Power/light switch |
| 13 | Using the machine |
| 13 | -Handwheel |
| 13 | -Two step presser foot lifter |
| 13 | -Changing the presser foot |
| 15 | -Inserting needles |
| 15 | -Raising the upper knife |
| 17 | Threading |
| 17 | -Threading/Preparation |
| 17 | -Upper looper (blue) |
| 19 | -Lower looper (red) |
| 21 | -Right needle (green) |
| 23 | -Left needle (yellow) |
| 23 | -After threading |
| 25 | Trial sewing, thread tension |
| 25 | -Sewing test |
| 25 | -Check your trial run |
| 27 | Adjusting the thread tension |
| 27 | -Adjusting the thread tension |
| 29 | Adjustments and settings |
| 29 | -Adjustment of stitch length |
| 29 | -Cutting width |
| 29 | -To change the stitch plate |
| 29 | -Types of stitch plates |
| 31 | Differential feed * |
| 31 | -Differential feed * |
| 31 | -Gathering * |
| 33 | Practical sewing |
| 33 | -3 thread overlock |
| 33 | -3 thread rolled hem |
| 33 | -Unpicking seams |
| 35 | Maintenance |
| 35 | -Changing light bulb |
| 35 | -Cleaning and lubricating |
| 37 | Trouble shooting guide |
| 41 | Technical data |

Details of the machine

Details of the machine

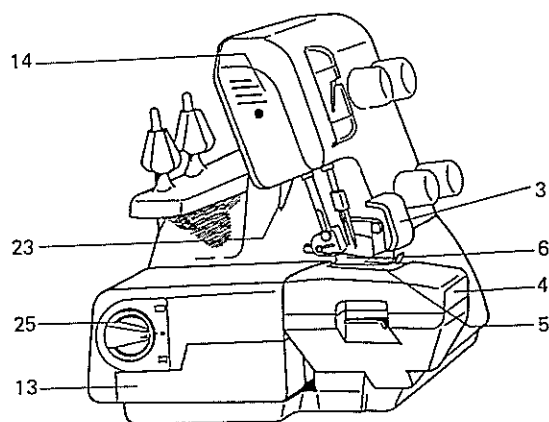
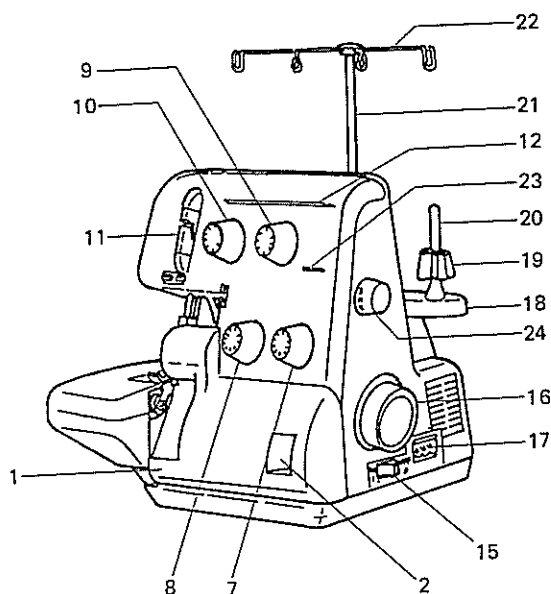

- 1 Looper cover
- 2 Looper cover opening indent
- 3 Knife guard
- 4 Cloth plate
- 5 Stitch plate
- 6 Presser foot
- 7 Lower looper tension dial
- 8 Upper looper tension dial
- 9 Right needle tension dial
- 10 Left needle tension dial
- 11 Thread take up cover
- 12 Thread guide plate
- 13 Accessory box
- 14 Bulb cover
- 15 Power/light switch
- 16 Handwheel
- 17 Machine socket
- 18 Thread stand
- 19 Anti-vibration cone
- 20 Spool holder pin
- 21 Retractable support rod
- 22 Open thread guide
- 23 Presser foot lifter
- 24 Stitch length dial
- 25 Differential feed dial*

Please note:

Model 134 is not equipped with differential feed. All points relating exclusively to 134D are marked with the symbol*

Preparing the machine

Accessories

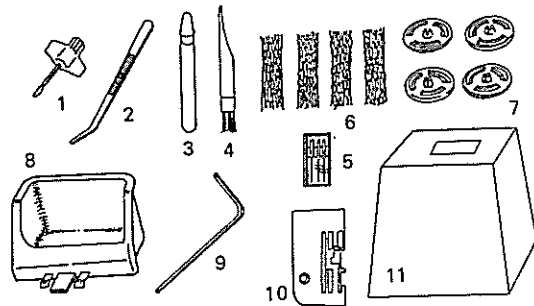

- 1 Screwdriver
- 2 Tweezers
- 3 Oiler
- 4 Cleaning brush
- 5 Set of needles HAX1
- 6 Net
- 7 Spool caps
- 8 Waste collector
- 9 Hexagon wrench
- 10 Roll hem stitch plate
- 11 Dust cover

Accessory Box

All standard accessories are stored in the box. Pull out to open, push in to close.

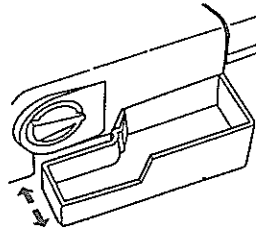

Looper cover

To open push to the right with your thumb in the indent and tilt towards you. To close push it up and the cover engages automatically.

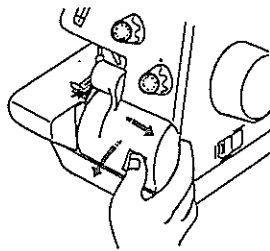

Waste collector

Fabric waste will be collected as you sew. Push the waste collector under the front of the machine and slightly to the left towards the cloth plate cover.

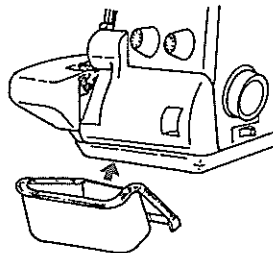

Cloth plate cover

To open push the lever up. To close push the cover up to the right, it snaps into position automatically.

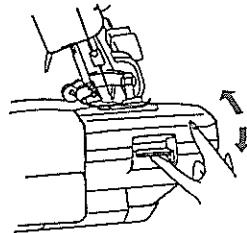

Preparing the machine

Attaching the foot control

Plug foot control into machine socket (A) and then into main socket (B).

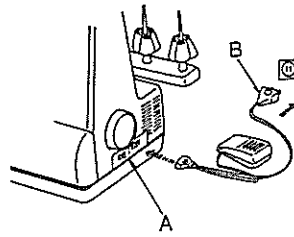

Foot controller Model 4C-315B for use with Sewing machine Model 134, 134D

Connect the controller source plug to electrical outlet shown as left figure. This appliance has a polarized plug (one blade wider than the other). To reduce the risk of electric shock, this plug is intended to fit in a polarized outlet only one way. If the plug does not fit fully in the outlet, reverse the plug. If it still does not fit, contact a qualified electrician to install the proper outlet. Do not modify the plug in any way.

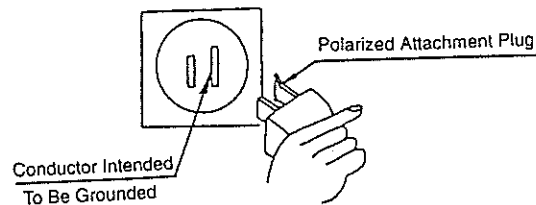

Sewing speed

The sewing speed can be adjusted by increasing or decreasing the pressure on the foot control (C).

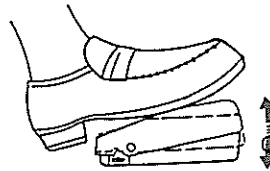

Assembling the thread stand

Raise the support rod fully, turning slightly until the positioning catches engage.

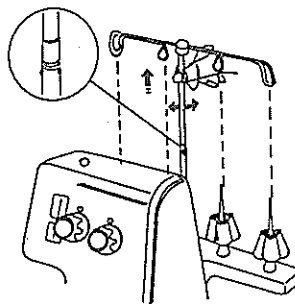

Thread cones

The anti-vibration cone should be used with the wider edge to the bottom on the spool holder pin when sewing with cones. When using household spools remove the anti-vibration cones. Place spool on spool holder pins and push the spool caps on. If threads slip and get twisted, cover the spools with the nets supplied in the accessory box.

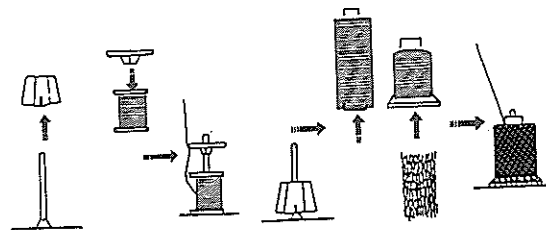

Using the machine

Power/light switch

The power switch is conveniently placed on the handwheel side of the machine.

"I" - ON
"O" - OFF

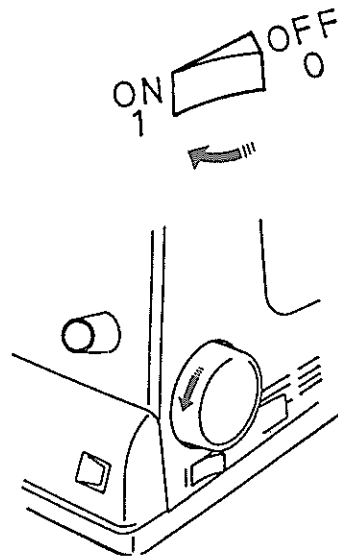

Handwheel

The handwheel turns counterclockwise.

Two step presser foot lifter

To raise the presser foot, raise the lever on the rear of the machine until it engages. The presser foot can be raised again to maximum height to provide more space between presser foot and stitch plate.

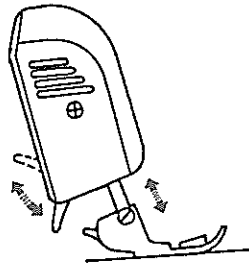

Changing the presser foot

-Switch the machine off "O".
-Raise the presser foot.
Press the catch (A) to release the presser foot from the clamp. Raise the presser foot lifter to the highest position and remove the presser foot sole to the left. To attach the presser foot sole, place it under the shaft. The groove in the shaft should line up exactly with the presser foot pin. Lower the shank and the presser foot will engage automatically.

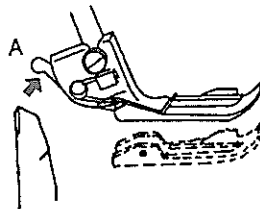

Using the machine

Inserting needles

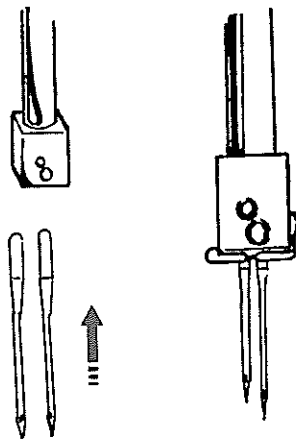

- Switch the machine off "0".
Disconnect machine from electricity supply.
- Turn the handwheel until needles are fully raised.
- Lower the presser foot.
- Use the hexagon wrench to loosen the needle setscrew. Remove needle.
- Insert the needle flat side towards the back, as far as possible into the needle clamp. Tighten the screw.
- The left needle is set higher than the right needle.

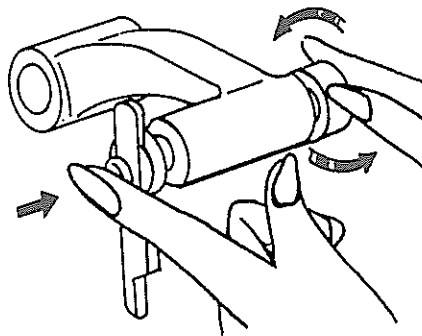

Raising the upper knife

- Turn the handwheel to raise the needles.
- Open the looper cover.
- Press the upper knife holder to the right. Turn the knob clockwise until the knife engages.
- Close the looper cover.

To lower the upper knife:

- Turn the knob anti-clockwise. The knife snaps automatically into its lower position. Close the looper cover.

Threading

Threading / Preparation

- Disconnect machine from electricity supply.
- Support rod with thread guide must be fully raised.
- Open the looper cover and the cloth plate cover.
- Turn the handwheel towards you until needles are fully raised.

- Thread the machine in the correct sequence.

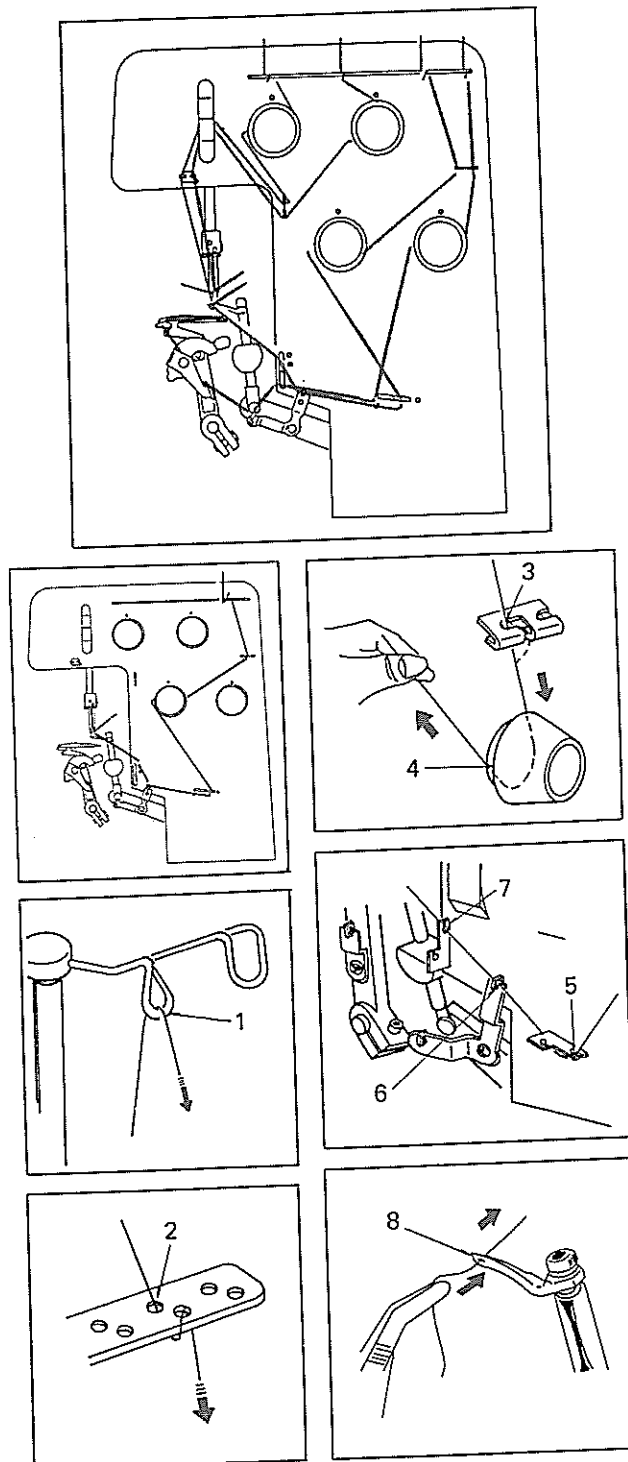

Upper looper (blue)

- Place the spool on the spool holder pin.
- Bring thread up from back to front through guide (1).
- Make S-loop through holes in thread guide bar (2).
- Thread guide (3).
- Thread from right to left around the tension dial (4). Pull thread gently. When a slight resistance is felt, the thread is lying correctly between the tension discs and is on the spring.
- Thread guides (5,6,7).
- Thread looper eye (8).
- Place thread under presser foot.

Threading

Lower looper (red)

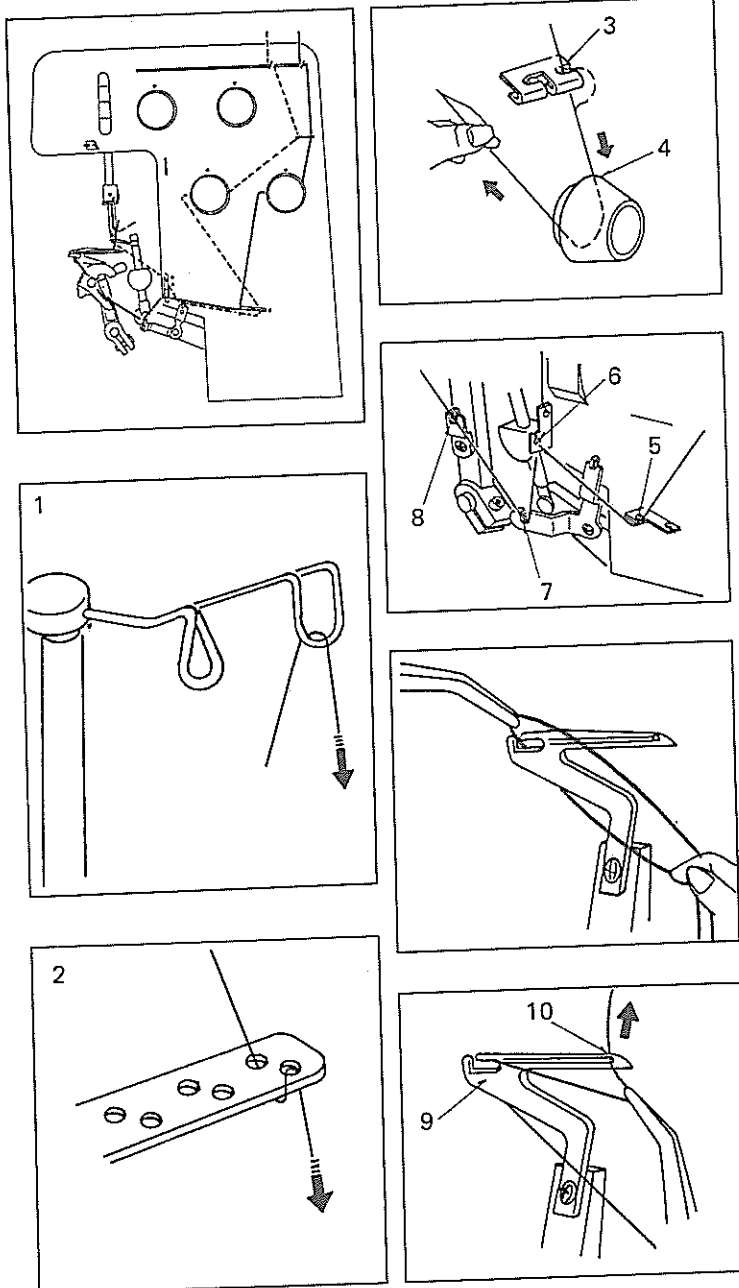

- Place the spool on the spool holder pin.
- Bring thread up from back to front through guide (1).
- Make S-loop through holes in thread guide bar (2).
- Thread guide (3).
- Thread from right to left around the tension dial (4). Pull thread gently. When a slight resistance is felt, it is lying correctly between the tension discs and is on the spring.
- Thread guides (5, 6, 7, 8).
- Turn the handwheel towards you until the lower looper is in the left-most position. Use the tweezers to pull a thread loop (not thread end) from right side to left. Insert the thread into the slit on the lower looper (9). Turn the handwheel towards you until the lower looper is in the rightmost position.
- Thread the looper eye (10) so that the thread lies in the long groove on the lower looper.
- Place thread under presser foot.

Note:

If the lower looper has to be re-threaded, cut both needle threads off at the needle eye and remove surplus thread from below. Thread the lower looper and then pull/re-thread the needles.

Threading

Right needle (green)

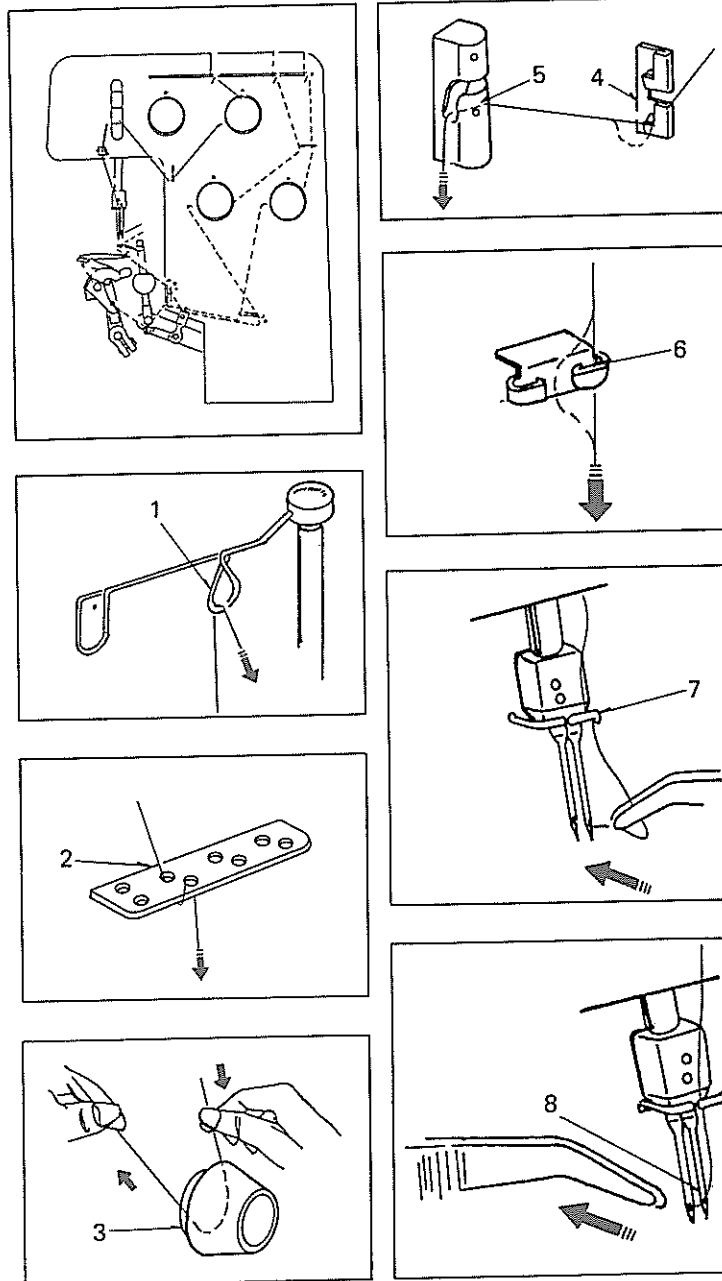

- Place the spool on the spool holder pin.
- Bring thread up from back to front through guide (1).
- Make S-loop through holes in thread guide bar (2).
- Thread from right to left around tension dial (3).
Pull thread gently. When a slight resistance is felt, it is lying correctly between the tension discs and is on the spring.
- Thread guide (4), thread take up (5), guides (6, 7).
- Thread right needle eye (8).
- Place thread under presser foot.

Threading

Left needle (yellow)

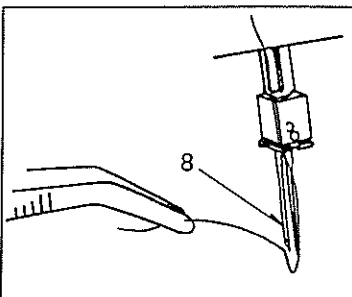
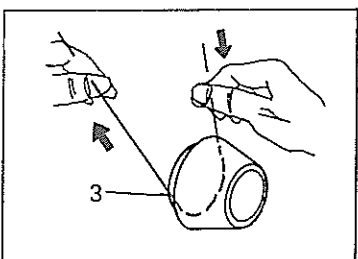
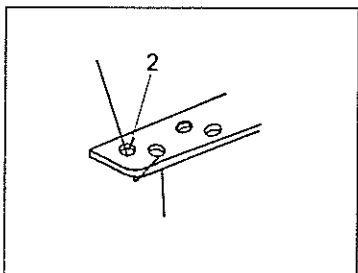
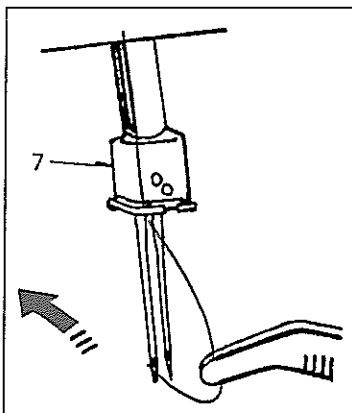
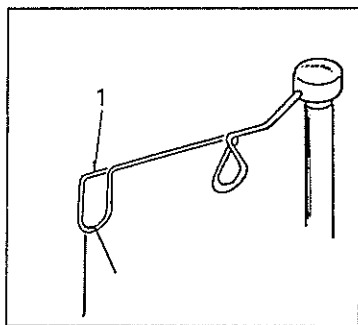
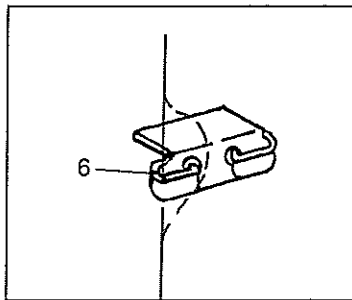
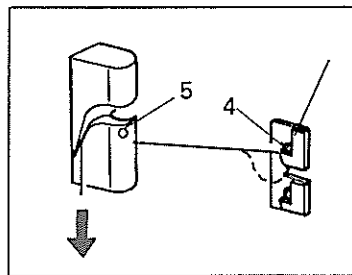
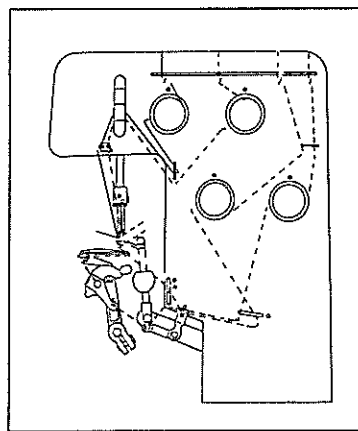

- Place the spool on the spool holder pin.
- Bring thread up from back to front through guide (1).
- Make S-loop through holes in thread guide bar (2).
- Thread from right to left around tension dial (3). Pull thread gently. When a slight resistance is felt, it is lying correctly between the tension discs and is on the spring.
- Thread guide (4), thread take up (5), guides (6, 7).
- Thread left needle eye (8).
- Place thread under presser foot.

After threading

When threading is complete, lower the presser foot and close the looper cover and cloth plate.

Note:

If the lower looper has to be re-threaded, cut both needle threads off at the needle eye and remove surplus thread from below. Thread the looper and then re-thread the needles.

Trial sewing, thread tension

Sewing test

After threading make a trial run. Always use a double layer of fabric in order to be able to check the stitch formation and thread tension properly.

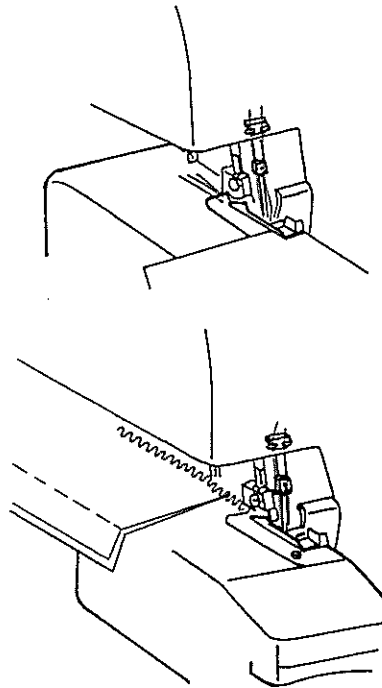

- Switch the machine on "1".
- Set all tension dials to 4.
- Raise the front of the presser foot slightly with your thumb and position the fabric under the foot just up to the knife.
- Sew.
- At the end of the seam continue sewing a 8cm (4") long thread chain.
- Cut the thread chain and remove work.

Check your trial run

- 1 Upper looper thread (blue)
- 2 Lower looper thread (red)
- 3 Right needle thread (green)
- 4 Left needle thread (yellow)

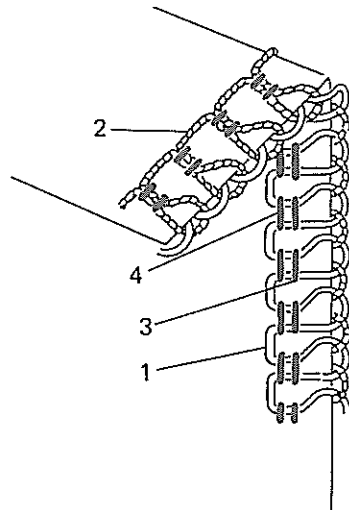

Perfect stitch formation is when both looper threads meet at the fabric edge. The needle threads form straight stitches for a stretchy and durable seam.

Thread tension adjustments may be required depending on the type of fabric and thread being used.

Adjusting the thread tension

Adjusting the thread tension

The left needle thread forms loops on the underside:

Tighten the left needle thread tension (yellow).

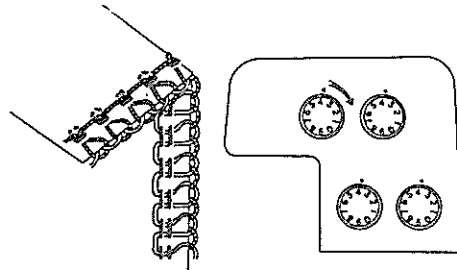

The right needle thread forms loops on the underside:

Tighten the right needle thread tension (green).

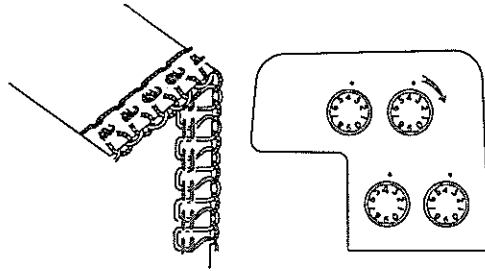

The looper loops are formed on the underside:

Tighten the upper looper tension (blue), or loosen the lower looper tension (red).

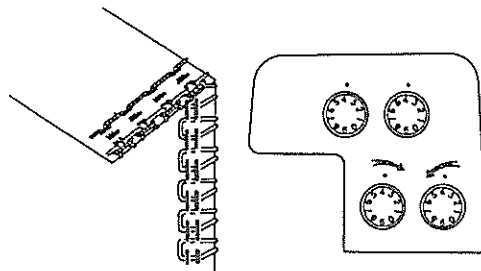

The looper loops are formed on the upper side:

Tighten the lower looper tension (red), or loosen the upper looper tension (blue).

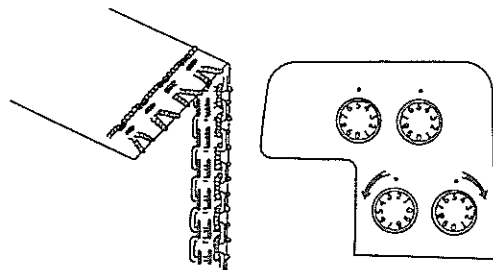

Adjustments and settings

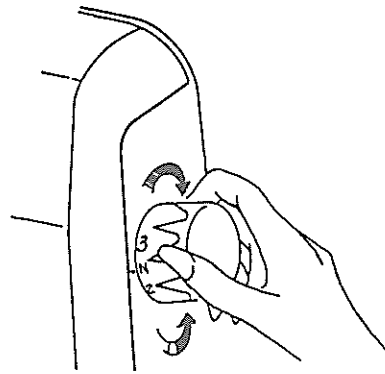

Stitch length

- The stitch length can be adjusted from 1 to 4 mm.
- Higher number = longer stitch, lower number = shorter stitch.
- Basic stitch length = N.

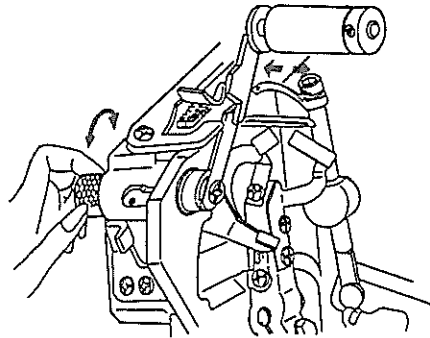

Cutting width

The cutting width should be adjusted according to the type of fabric being sewn. Check the seam each time and adjust the cutting width accordingly.

Adjusting the cutting width:

- Open cloth plate cover
- Turn cutting width dial:
- Clockwise to move knife to the left (for heavier fabrics).
- Counter-clockwise to move the knife to the right (for lighter fabrics).

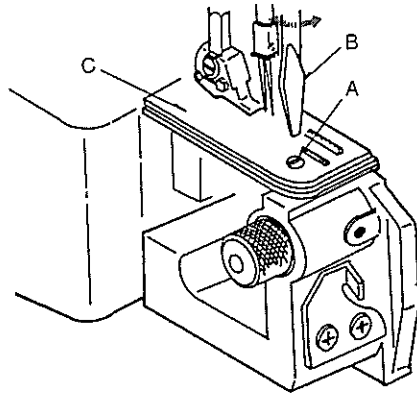

To change the stitch plate

- Disconnect machine from electricity supply.
- Turn the handwheel to raise the needles.
- Remove the presser foot
- Release setscrew (A) with screwdriver (B).
- Remove the stitch plate (C) by lifting up and to the left.

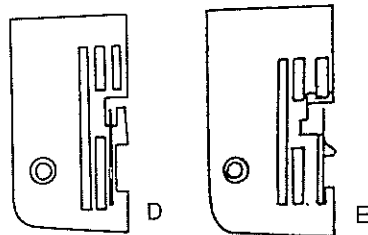

- Reset stitch plate.
- Tighten the stitch plate setscrew.
- Attach and lower the presser foot.

Types of stitch plates

Stitch plate for overlock (D).
Stitch plate for roll hem (E).

Differential feed*

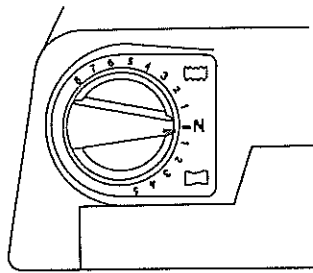

Differential feed*

There are two feed dogs: one front and one rear. The two feed dogs move independently and the distance each feed dog travels during one complete movement can be adjusted.

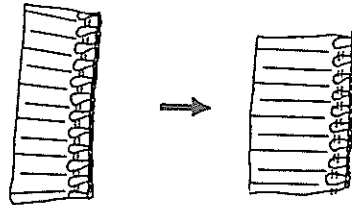

Stretching effect

To stretch the fabric select a number from N to 5 in the section "  ".

This prevents fine nylon jerseys or closely woven fabrics from puckering.

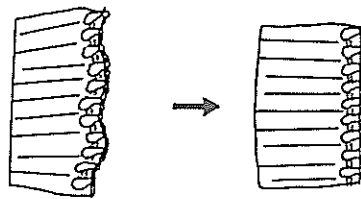

Pushing effect

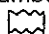
To prevent waving or to gather select a number from N to 8 in the section "  ".

This prevents waving or fluting in knits or puckers in fine woven fabrics. It also can be used to gather single layers of fine woven fabric.

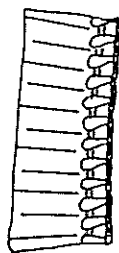

Note:

When sewing without differential feed the dial should be on position N.

Gathering*

Use the differential feed to gather a single layer of fabric. For example sleeve heads, yokes, lace edging or frills.

Adjustment:

Stitch: 4-thread overlock
Differential feed: 8
Stitch length: 3-4
Thread tension: 3-5

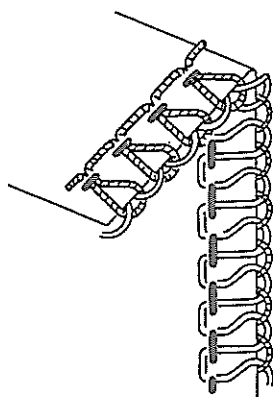

3 thread overlock

For a 3-5 mm wide 3 thread overlock, remove the left needle. Thread both loopers and then the right needle.

For a 5-7 mm wide 3 thread overlock, remove the right needle. Thread both loopers and then the left needle.

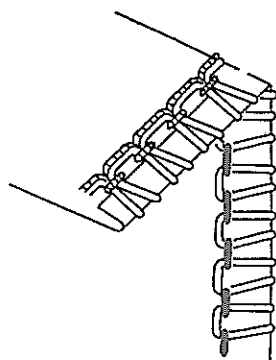

3 thread roll hem

The roll hem stitch plate is in the accessory box.

Note:

The tensions may need to be adjusted depending on the type of fabric or thread being used.

Setting:

| | |
|-------------------|-------------------------|
| Stitch: | 3 thread overlock |
| Needle: | right |
| Tensions: | |
| Needle: | 3-5 |
| Upper looper | 3-5 |
| Lower looper | 7~9 |
| Stitch length | 1.5~2 |
| Differential feed | N (depending on fabric) |

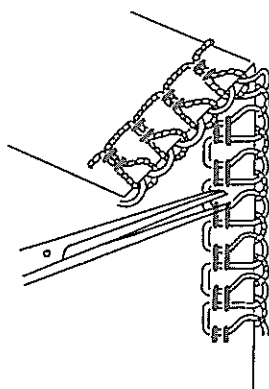

Unpicking seams

Cut the loops with sharp scissors. Pull the needle thread and the stitches will come undone.

Maintenance

Knives

The knives are made from special material and are very durable. They can be replaced by your local dealer if the blades become dull or damaged.

Changing light bulb

- Switch the machine off "O" and disconnect it from electricity supply by removing the mains plug.
- Loosen the bulb cover setscrew (A) and remove the bulb cover.
- Unscrew the bulb and replace it with a new one.
- Attach bulb cover and retighten the setscrew.

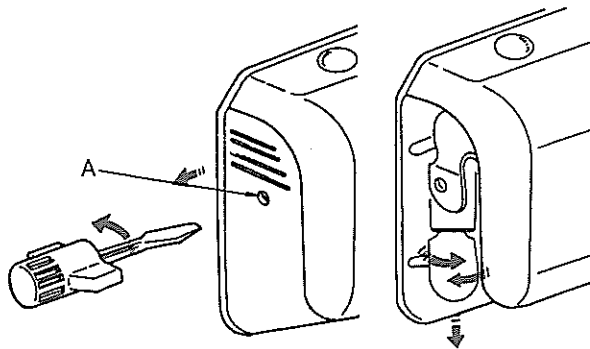

Note:

Always use 110V/230V/240V 15W bulbs. Bulbs are available from your local dealer.

Cleaning and lubricating

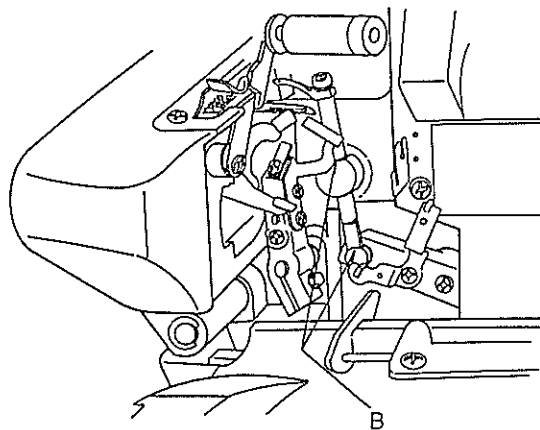

- Disconnect machine from electricity supply.

During sewing dust and fluff collect in and on the machine. This should be removed regularly.

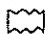

Your overlocker requires very little lubrication but if used frequently, lubricate the points illustrated (B) with a drop of oil.

Trouble shooting guide

| | | | |
|-----------------------------|--|---|----------------|
| Thread breaks | Thread tension is too tight for thread used. | Reduce thread tension. | 27 |
| | The machine is not threaded correctly. | Check the threading. | 17/19 21/23 |
| | Needles are incorrectly inserted. | Insert needles fully into needle clamp with flat side to the back. | 15 |
| Needles break | Needles are bent, blunt or the points are damaged. | Replace the needles. | 15 |
| | Needles not inserted correctly. | Insert needles fully into needle clamp with flat side to the back. | 15 |
| | Fabric was pulled while sewing. | Guide fabric gently with both hands. | 25 |
| Skipped stitches | Needles are bent or blunt. Wrong needles used. | Replace the needles. Use system HAX1 (130/705H) needles. | 15 |
| Poor stitch formation | Thread is not wound correctly round tension dials. | Check threading. | 17/19 21/23 |
| Seams flute or wave (knits) | Differential feed is set incorrectly. Fabric was pulled while sewing. | Adjust differential feed between N and 8 "  ". | 31 |
| Seams pucker | Differential feed is set incorrectly. | Adjust differential feed between N and 5 "  ". | 31 |
| Fabric edges curl | Too much fabric in the stitch formation. | Reduce cutting width, knife to the left. | 29 |
| Thread loops are loose | Too little fabric in the stitch formation. | Increase the cutting width, knife to the right. | 29 |
| Machine does not sew | Cord not plugged in correctly. | Check plug. | 11 |
| | Main switch not on. | Switch machine on " 1 ". | |

Technical data

Données techniques

| | |
|--|--|
| <p>Stitch types: -2 needles, 4 thread overlock with integrated safety seam -1 needle. 3-thread overlock, 3 thread rollhem, 3 thread flatlock</p> <p>Needle system: HAx1 (130/705H)</p> <p>Seam width: 3-7 mm</p> <p>Stitch length: 1-4 mm</p> <p>Presser foot lift: max. 6mm</p> <p>Handwheel: rotates counter-clockwise</p> <p>Sewing speed: up to 1300 s.p.m.</p> <p>Weight: Bernette 134D 7.3 kg Bernette 134 7.0 kg</p> <p>Dimensions: 292Wx295Dx290H mm</p> | <p>Points réalisables: - 2 aiguilles, surjet à 4 fils avec point de sécurité intégré - 1 aiguille, surjet à 3 fils Ourlet roulé à 3 fils Couture plate à 3 fils</p> <p>Système d'aiguille: HAx1 (130/705 H)</p> <p>Largeur de couture: 3 - 7 mm</p> <p>Longueur de point: 1 - 4 mm</p> <p>Élévation du pied-de-biche: 6 mm au max.</p> <p>Rotation du volant: En sens inverse des aiguilles d'une montre</p> <p>Vitesse de travail Jusqu'à 1300 points,omite/mi</p> <p>Poids: 7.0kg</p> <p>Dimensions: 292 (L) x 295 (P) x 290 (H) mm</p> |
|--|--|

| | |
|---|--|
| <p>Standard accessory: Dust cover</p> | <p>Accessoires standard Housse de protection</p> |
|---|--|

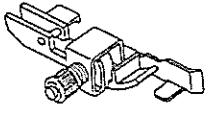
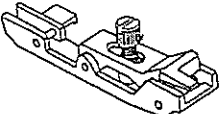
| | Special accessories | Accessoires spéciaux: |
|---|--|---|
|  | Blind stitch foot | Pied pour points invisibles |
|  | Elasticator foot | Pied pour poser des élastiques |
| | Special accessories are available from your dealer | Les accessoires ad speciaux sont disponibles auprès de l'agent: |